

Overview of Basic Switches

Basic Switches

A Basic Switch is a small switch with a very small contact gap and snap-action mechanism and with a contact structure that switches for a specified movement and specified force enclosed in a case with an actuator provided on the exterior of the case.

The following Basic Switch structure is shown as an example.

Basic Switches are mainly comprised of five components.

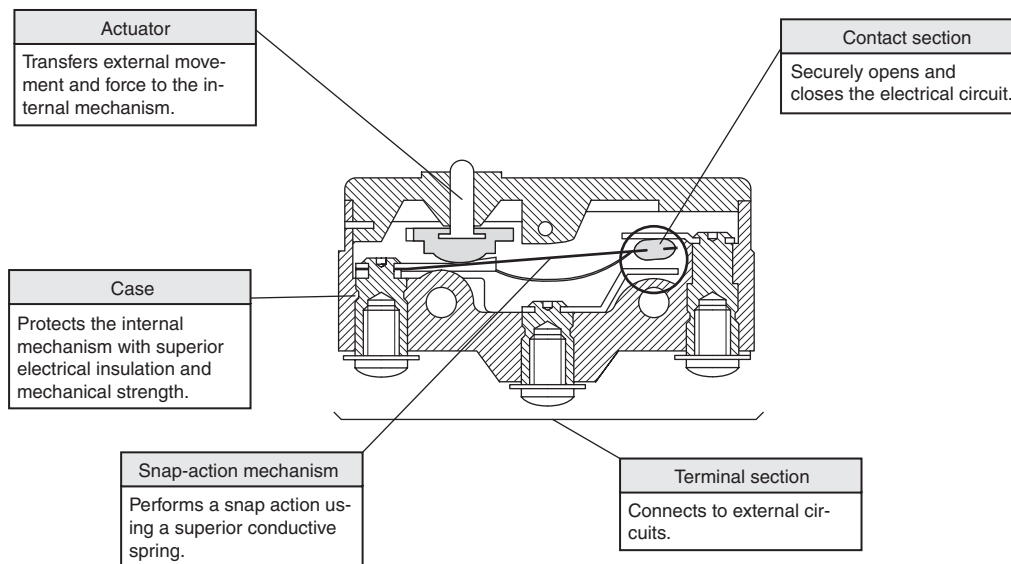

Structural Diagram of Typical Basic Switch